

957S

SINOMACH

SINOMACH

SINOMACH-HI INTERNATIONAL EQUIPMENT CO.,LTD.

Optional Attachment



侧卸
Side-dump Bucket



加长臂
Extension Arm



石油管抓具
Petroleum-pipe Clamp



枝桠材抓具
Branch Clamp



木爪
Log Clamp



小容量抓具
Small capacity clamp



大容量抓具
Large capacity clamp



岩石斗 (2.2m³)
Rock Bucket

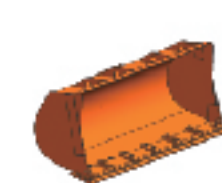

煤斗 (3.8m³)
Coal Bucket

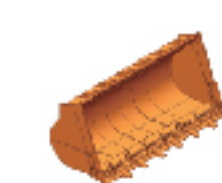

矿砂斗 (2.2m³)
Ore Bucket

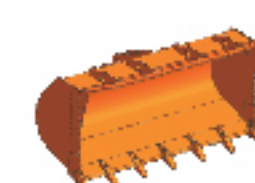

加大斗 (4.5m³)
Large Capacity Bucket



Wheel Loader



Motor Grader



Excavator



Backhoe Loader



Vibratory Roller



Pneumatic Roller



Bulldozer



Truck Mounted Crane



Skid Steer

额定功率(Rated Power):160kW@2200rpm(Cummins) / 162kW@2200rpm(Shanghai)
操作重量(Operating Weight):16700Kg 额定斗容(Rated Bucket Capacity):3.0m³



- Equipped with Cummins 6LTAA9.3 / SHANG CHAI SC11CB220G2B1 engine.
- Outstanding ZF fixed shaft T/M and 3-elements are mature and reliable.
- Easy, accurate and flexible imported single-handle P. P.C system, bucket automatic leveling device, assure operation quick and reliable.
- KD switch owns better efficiency and easy operation.
- Luxury cab decoration and A/C and adjustable steering wheel provide operator more space and comfort.
- Key components of international brands are used to enhance reliability.



SINOMACH-HI INTERNATIONAL EQUIPMENT CO.,LTD.
Add:No.36Huashan middle road, Changzhou, Jiangsu,
P.R.of China
P.C:213136
Tel:86-519-86781388
Fax:86-519-86781387
Http://www.changlin.com.cn
E-mail:sales@changlin.com.cn service@changlin.com.cn

DEALER:

 **国机重工集团国际装备有限公司**
SINOMACH-HI INTERNATIONAL EQUIPMENT CO.,LTD.

 **国机重工**
SINOMACH

